

Soerat tetapan di atas hak roemah dengan haknja menempati pekarangan.

No. 57/40  
Lampiran: 5

Djokjakarta, 20 November 1910..

Pamarintah di Kadipaten PAKOEALAMAN soedah menetepken, jang *sasaran*  
benama *Basiran* benamah di kampoeng *Ledoh Lari, Pajagalan*  
mendapat hak di atas *saboe* boewah roemah, dengan haknja menempati pekarangan No. *224*  
di kampoeng *Pajagalan* Blok *A* No. *56* Oekoeran pandjang  
*10.* M. lebar *6.50* M. djadi loewasnja ada *65.* M<sup>2</sup>. ( *R.R□.* )  
Tonggo seblah lor *Dok Lodinoma*  
" " wetan *Pajagalan besar Ledoh Lari*  
" " kidoel *it kelijit dari kali*  
" " koelon *Kali "Tjoh"*  
atsal *beli* dari *Dok Bongsodirjo, di kampoeng*  
*Pajagalan*  
(terseboet pratelan dari Kepala *kampoeng Koba Pakoealaman*  
tertanggal *21 Oktober 1910*  
No. *51* ) *dengan* harga f *90.-* (terbilang *sembilan puluh*  
*roepijah* ).  
Dan *Basiran* terseboet di atas di temtoeken menetepi  
soerat printah tertanggal 29 Juni 1903 No. 959/A.

Terbikin boewat

*Original*

Soedah tjotjok dengan Register  
dan adanja semoewa katrangan.

Sous-Chef Secretarie,





Ag. copy no 3948/40  
22-10-1918

1918  
24/10/18

1918

Handwritten notes in the left margin, including the date 24/10/18 and other illegible scribbles.

Main body of handwritten text, appearing to be a letter or report, written in cursive and partially obscured by a large watermark.

Handwritten notes in the lower-left margin, including the date 24/10/18.

Handwritten notes in the bottom-left margin, including the date 24/10/18.

746

Bottom section of handwritten text, including a signature and the number 50-2 in the bottom right corner.



Handwritten text at the top of the page, possibly a title or header, written in a cursive script.

Main body of handwritten text, consisting of several lines of cursive script, likely a letter or a document.

Handwritten text at the bottom of the page, possibly a signature or a closing line.

BRADY



Handwritten text at the top of the page, possibly a header or title, written in a cursive script.

Main body of handwritten text, consisting of several lines of cursive script. The text is dense and appears to be a detailed account or list.

Handwritten text at the bottom right of the page, possibly a signature or a date.

BRADLEY



Handwritten notes at the top of the page, including the number '12' and some illegible cursive text.

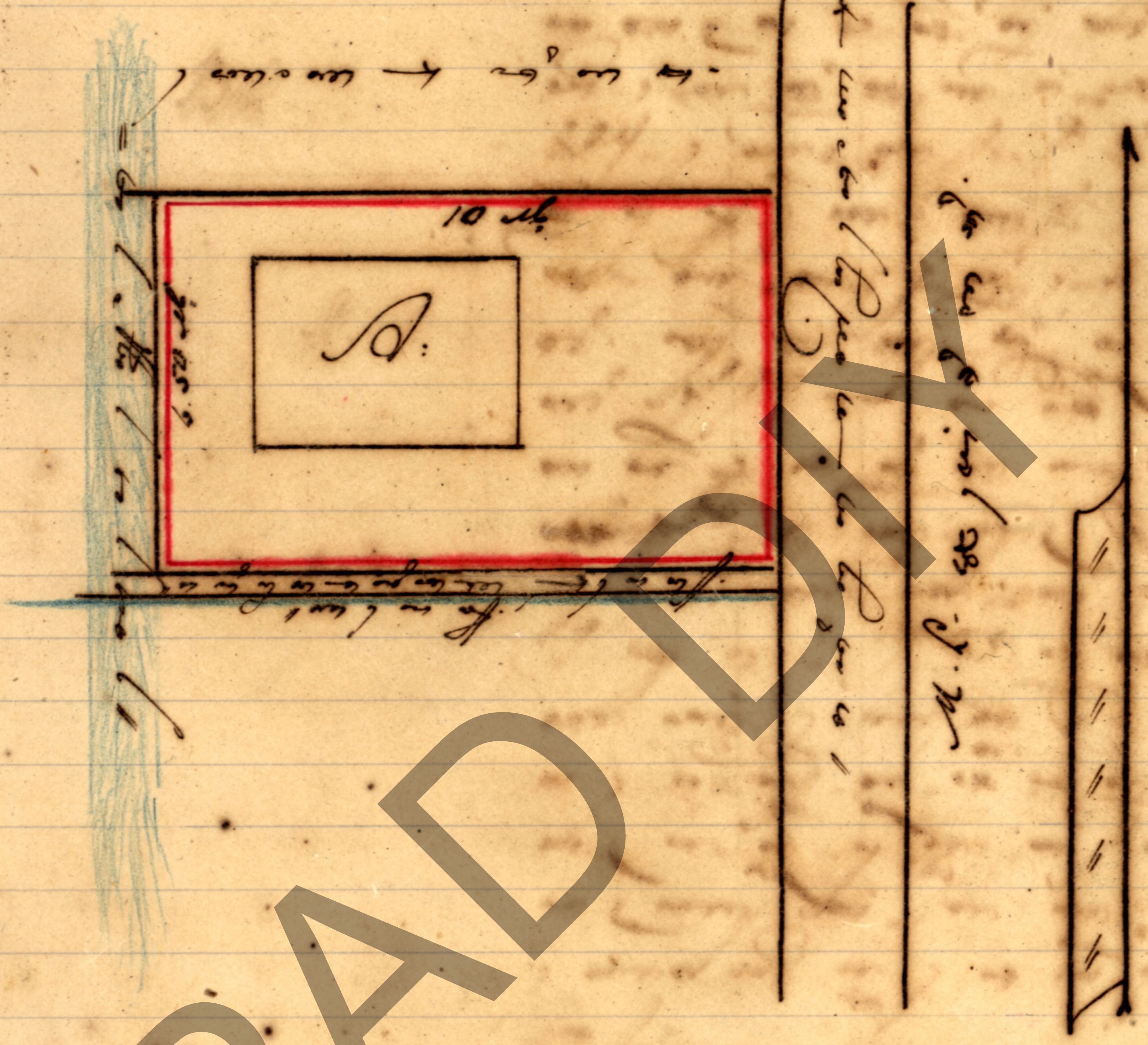

Handwritten notes below the diagram, including a red horizontal line and a blue horizontal line.

Handwritten signature or notes at the bottom of the page.





- Batas pekarangan
- L Romah bangun hampoaing.