

Soerat tetepan di atas hak roemah dengan  
haknja menempati pekarangan.

No. 60/140

Djokjakarta, 17 Juli 1920.

Lampiran: 5

Pamarintah di Kadipaten PAKOEALAMAN soedah menetepken jang  
Sorang bernama Tockiman Ep Djagalau  
mendapat hak di atas boewah roemah, dengan haknja menempati pekarangan No. 20  
di kampoeng Goenoengketar Blok XX No. 14 Oekoeran pandjang  
20 M. lebar 12 M. djadi loewasnja ada 240 M<sup>2</sup>. (  R. R.  )  
Tonggo seblah lor Moeshamat djair  
" " wetan Djaja reji  
" " kidoel Baro ojuwika  
" " koelon Tiksemit  
atsal pembelian dari Tiksemit kampoeng Goenoeng  
keloer  
(terseboet pratelan dari Kepala kampoeng kota P Alaman  
tertanggal 20 April 1920  
No. 23 ) dengan harga f 215 terbilang ( Duwaratus lima  
blas roepijah ).  
Dan Tockiman terseboet di atas di temtoeken menetepi  
soerat printah tertanggal 29 Juni 1903 No. 959/A.

Terbikin boewat Original

Soedah tjotjok dengan Register.

dan adanja semoewa katrangan

Sous-Chef Secretarie,

Raden Mas Rio

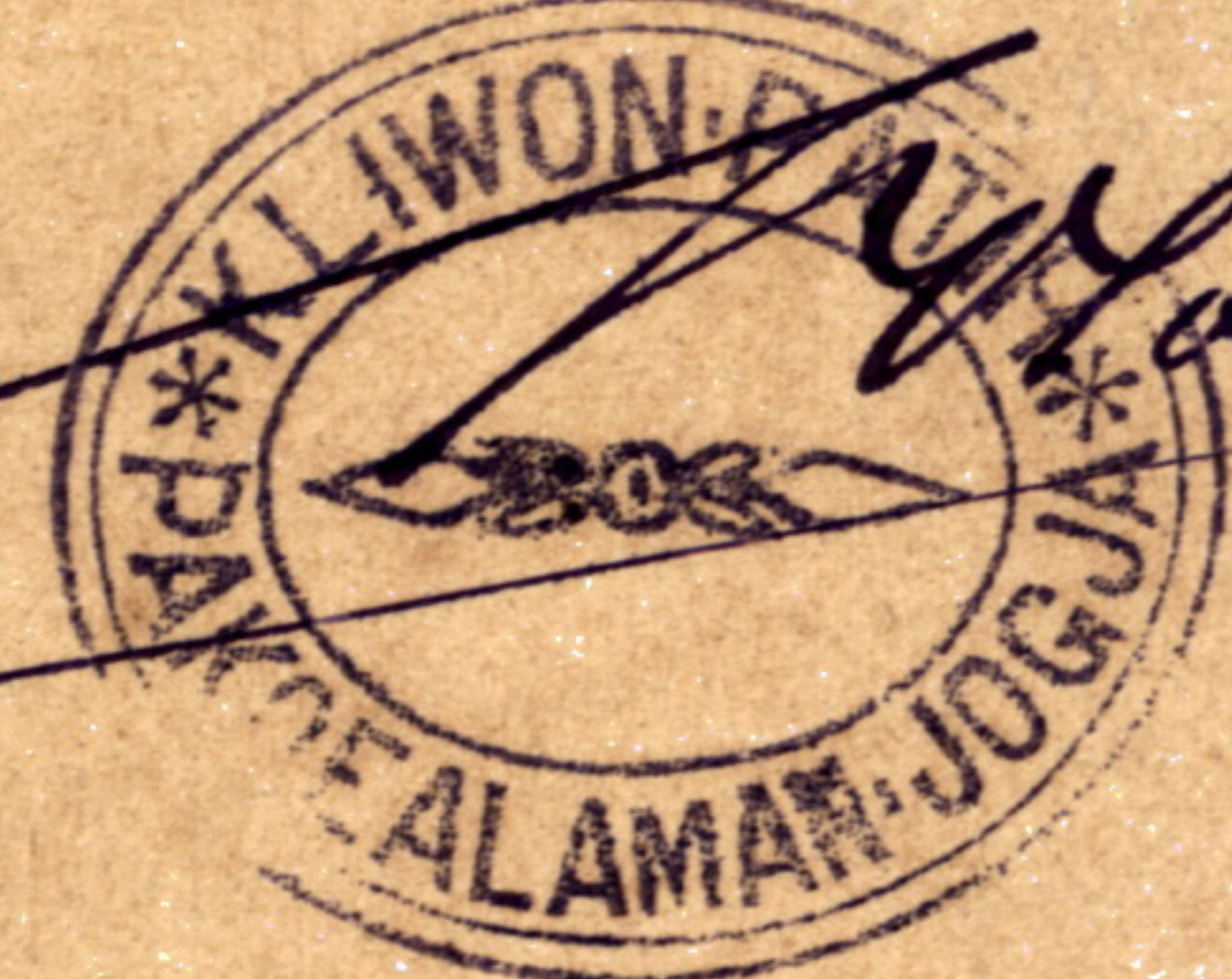

Gambar pakarannya Toekiman di Kampung  
Gempungketar Blok R.M. N: 14 Kiangkok or N: 20

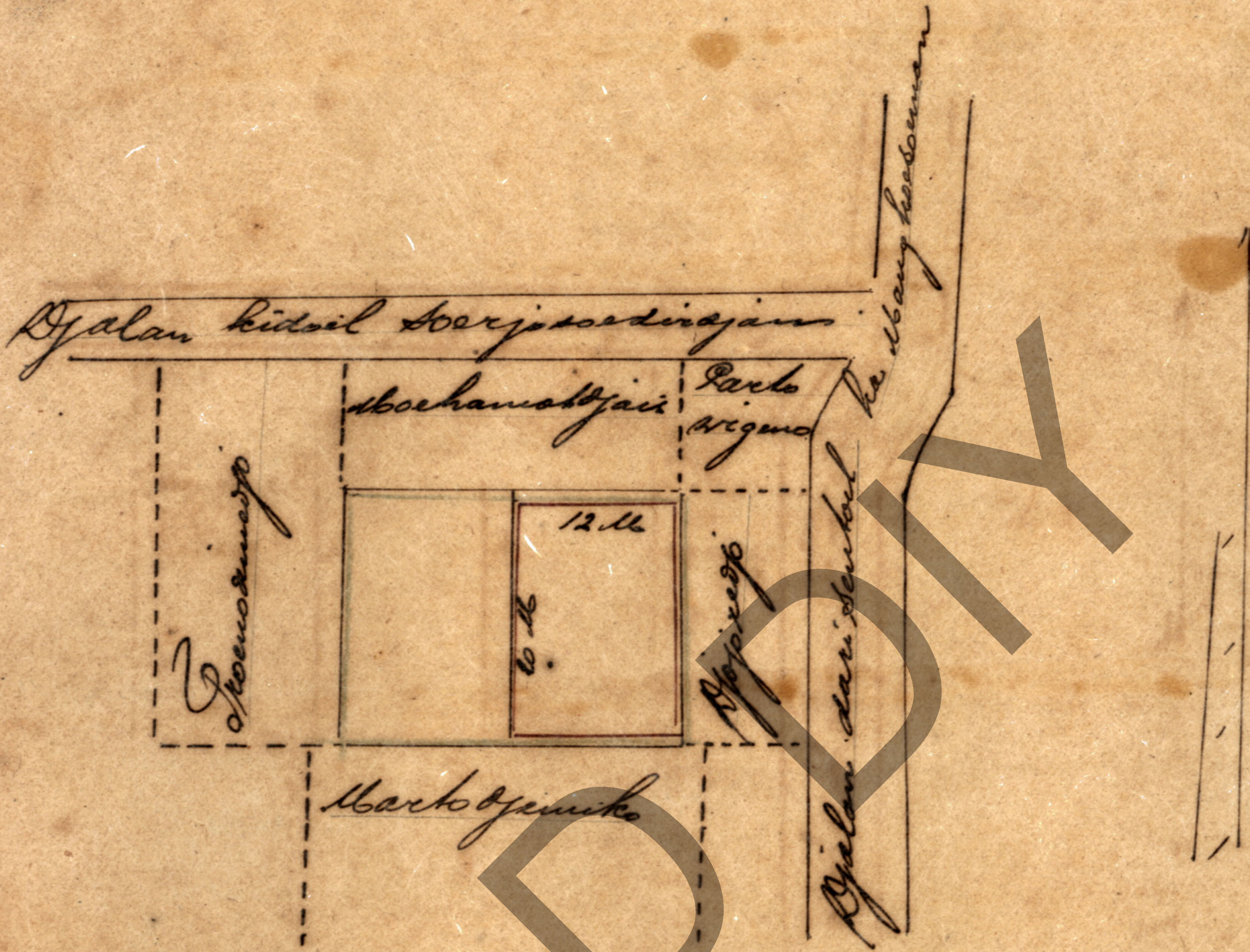

Likis pakarannya Jansawa  
Likis pakarannya

No 23.

3

392/40  
4-1920

Handwritten notes on the left margin, including numbers like 10/15, 10/20, and 18/5-20.

Handwritten text in Burmese script, top section, containing numbers like 20 and 12.

Handwritten text in Burmese script, middle section, containing numbers like 20 and 1920.

853

Handwritten notes at the bottom left, including the word 'လေး' (Lay).

Handwritten notes at the bottom right.

Large handwritten signature or flourish at the bottom right.

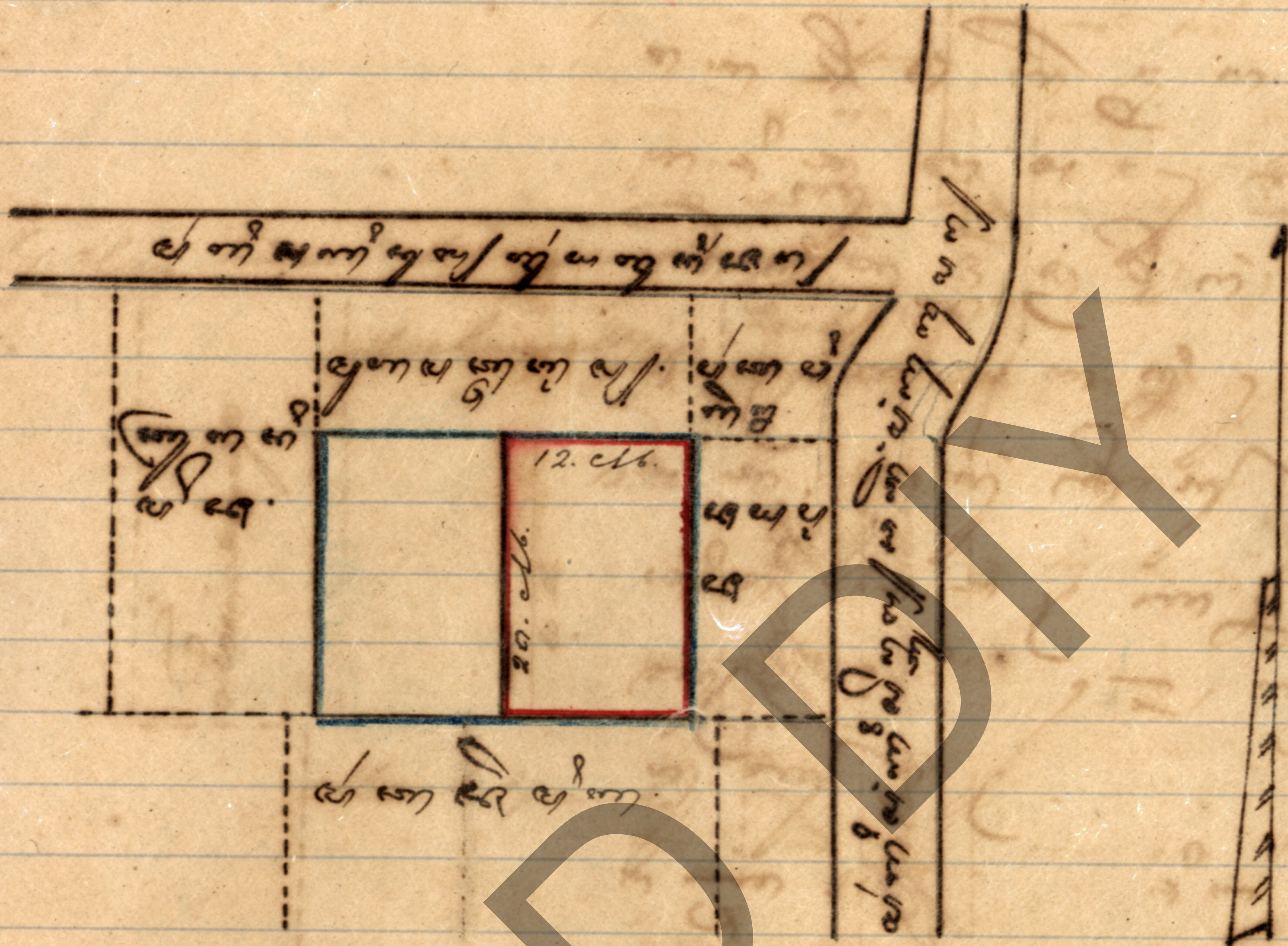

— အရှေ့ဘက် အနောက်ဘက် အလယ်ဘက် အရှေ့ဘက် အနောက်ဘက်  
— အရှေ့ဘက် အနောက်ဘက် အလယ်ဘက် အရှေ့ဘက် အနောက်ဘက်

အရှေ့ဘက် အနောက်ဘက်  
 အလယ်ဘက် အရှေ့ဘက် အနောက်ဘက်

1920. 12 27 3 11

Handwritten text in Devanagari script, likely a header or introductory section.

Handwritten text in Devanagari script, continuing the main body of the document.

20 12 1920

Handwritten text in Devanagari script, including a section with a large '20' at the start.

Handwritten text in Devanagari script at the bottom of the page, possibly a signature or closing.

12. 6. 1920

Handwritten text in Devanagari script, likely a header or introductory part of a document.

Main body of handwritten text in Devanagari script, containing several lines of prose.

20. 11. 12. 11.

Second main body of handwritten text in Devanagari script, continuing the narrative or report.

Handwritten signature or name at the bottom of the page.