

Soerat tetapan di atas hak roemah dengan
haknja menempati pekarangan.

No. 37/40

Djokjakarta, 12 Mei 1920

Lampiran: 5.

Pamarintah di Kadipaten PAKOEALAMAN soedah menetepken jang

Pradjadono di Toba gedé
mendapet hak di atas Amput boewah roemah, dengan haknja menempati pekarangan No. 26
di kampoeng Djagalar Blok B No. 4 Oekoeran pandjang
15 M. lebar 18 M. djadi loewasnja ada 195 M². (R. R.)

Tonggo seblah lor Djojodihardjo
" " wetan Hasandibromo dan Amopawiro
" " kidoel Djojowicakmo
" " koelon Djalar ketjil
atsal pembelian dari Pebel Prawirobawa

(terseboet pratelan dari Kepala kamp. Kota Pakoe Alaman
tertanggal 2 April 1920

No. 19) dengan harga f 1.000 terbilang (Seriboe roepijah
di taksir)

Dan Pradjadono terseboet di atas di temtoeken menetepi
soerat printah tertanggal 29 Juni 1903 No. 959/A.

Terbikin boewat Origineel

Soedah tjotjok dengan Register
dan adanja semoewa katrangan

Sous-Chef Secretarie,

Raden Mas Rio



Gambar rumah dan pekarangannya Projodrono^{di}Kamp
 Djagalan. Blok B n: 7
 hängkok N: 36.

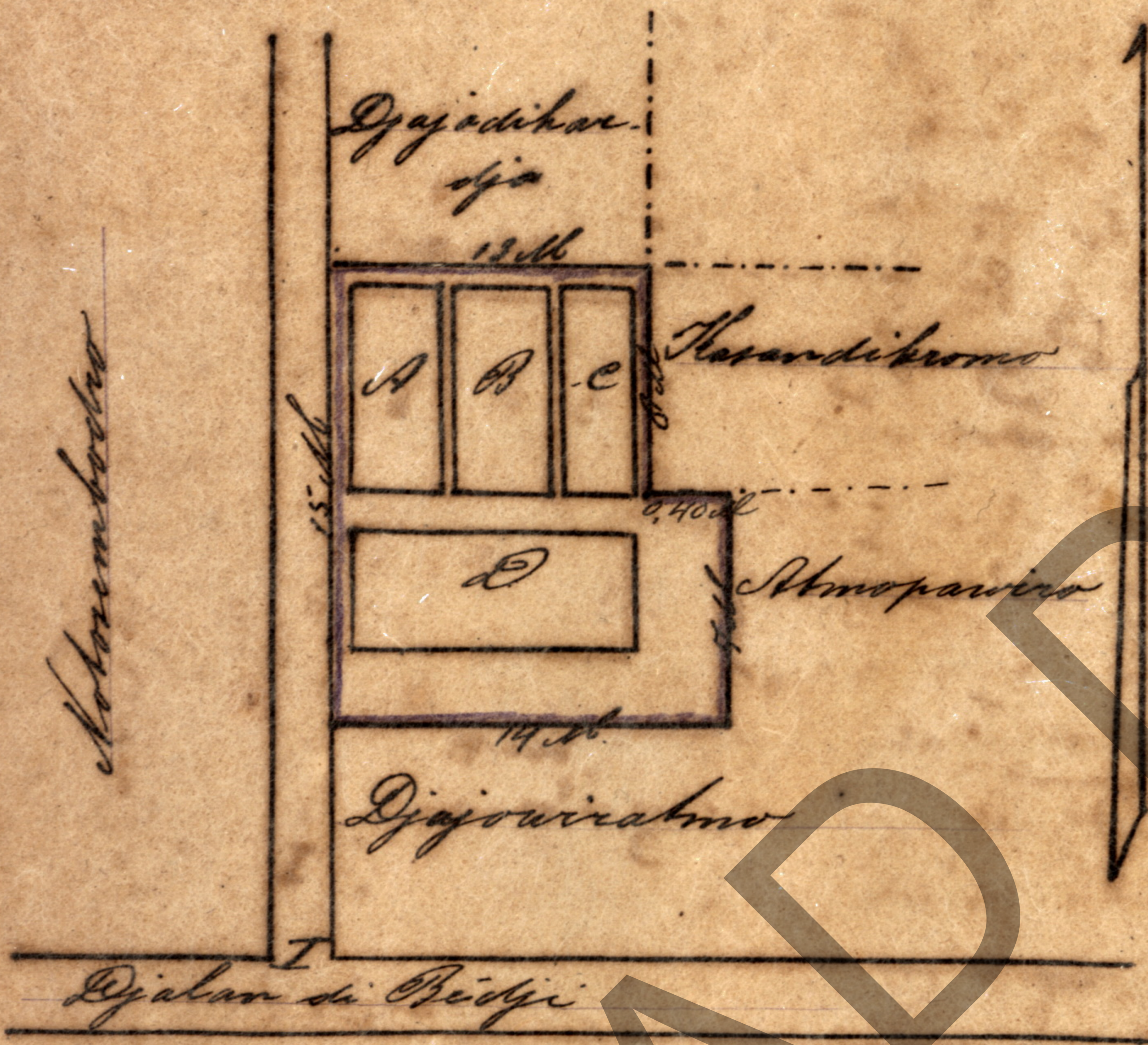

Tjebis pekarangan

A. B. C. rumah limasan, gandong tiga, pager tembok.

D. Thekal, limasan, pager gedig.

I Djagalan kejjil n: 1 dari witar

No 19.

... 3.

... 1920

Handwritten notes: *10/11/20*, *1920*, *777/40*

Vertical handwritten notes on the left margin: *Bekel*, *1000*, *10/11/20*, *1920*

Main body of handwritten text in a cursive script, likely a letter or document. Includes a large signature in the middle.

Handwritten notes at the bottom left: *26/4*, *1920*, *753/40*, *Goudschri: dan*, *wel full:*, *onderdan*, *de vermeld*

Handwritten notes and signatures in the lower right section.

Handwritten notes at the bottom left: *1920*, *10/11/20*, *1920*

Large handwritten signature at the bottom right.

1910

Handwritten notes in Malayalam script at the top of the page, partially obscured by the diagram.

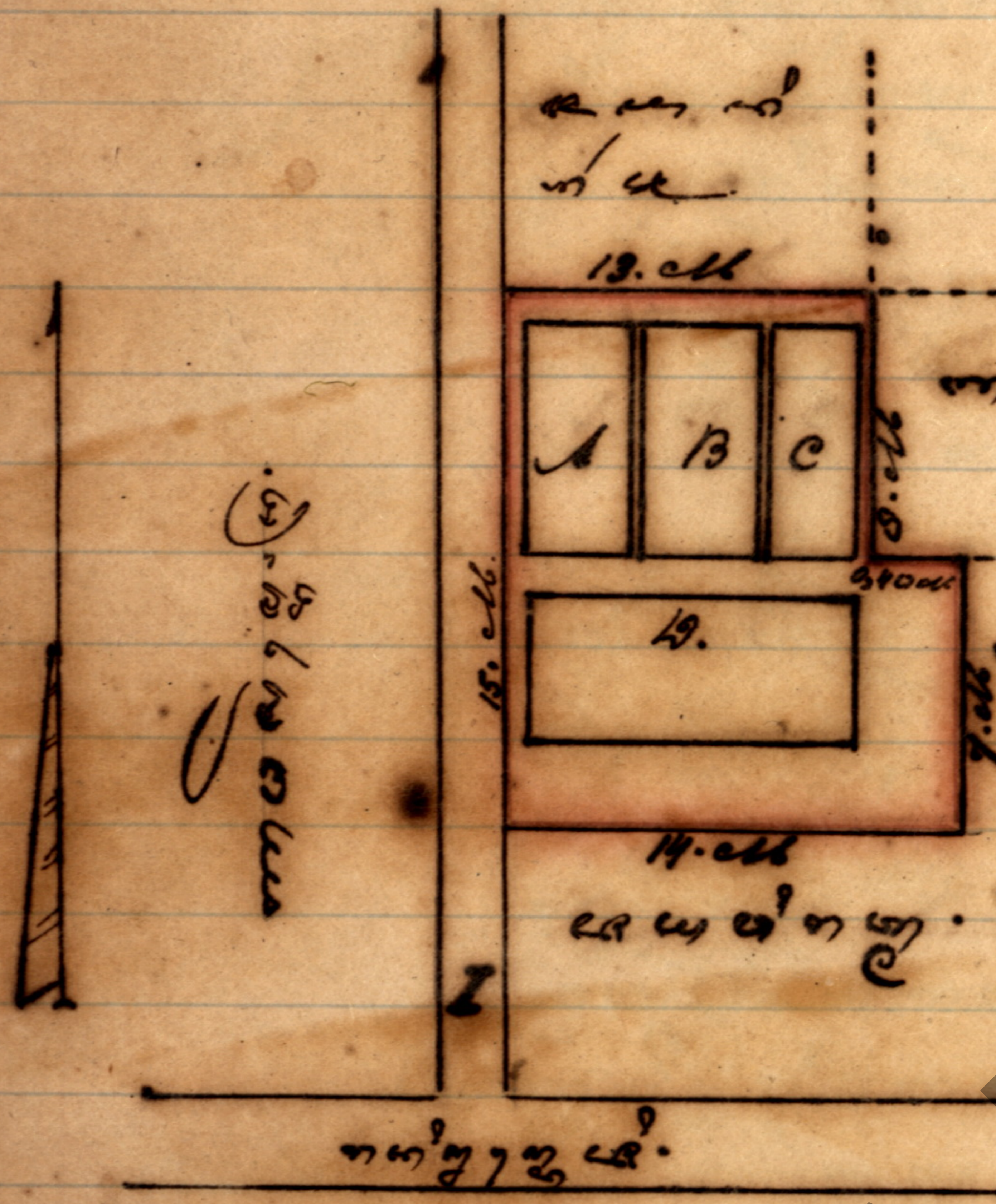

Extensive handwritten notes in Malayalam script on the right side of the page, providing details and context for the diagram.

- 1. കെട്ടിടം
- 2. കെട്ടിടം
- 3. കെട്ടിടം
- 4. കെട്ടിടം
- 5. കെട്ടിടം

Handwritten signature and notes at the bottom of the page.

1919

1920

Handwritten text at the top of the page, including the number 1920.

Main body of handwritten text, appearing to be a list or account with various entries and numbers.

BRAD

Handwritten signature or name at the bottom right.

1890. 10. 20. 1900.

Handwritten text at the top of the page, including a date and some illegible script.

Main body of handwritten text, appearing to be a list or account, with some numbers and names visible.

BRAD

Handwritten signature or name at the bottom of the main text block.

Handwritten text at the very bottom of the page.