

Soerat tetapan di atas hak roemah dengan haknja menempati pekarangan.

No. 1950/ id no 50/40 Djokjakarta, 24- Juli 1919

Lampiran :

Pamarintah di Kadipaten PAKOEALAMAN soedah menetepken jang Hadji Djail beromah di kampoeng Koeman Pakoe Alaman.

mendapat hak di atas ~~boewah roemah~~ dengan haknja menempati pekarangan No. 124

di kampoeng Koeman Blok 76 No. 23 Oekoeran pandjang

41,50 M. lebar 32,05 M. djadi loewasnja ada 1330 M². (16, - R. R.)

Tonggo sebelah lor Djalan besar moeka Kapatian

" " wetan Kampoeng dan Hadji Brahim

" " kidoel Hadji Abdolrahim dan Hardjamerdojo

" " koelon Abdolwatah dan Abdikmin

atsal pemberian dari Raden Mas Haris Lowioatmoedjo

(terseboet pratelan dari Kepala Kampoeng Lota Pakoe Alaman

tertanggal 18 Juli 1919

No. 52) dengan harga f 3,500. (terbilang Tiga riboe lima ratoes roepiah)

Dan Hadji Djail terseboet di atas di temtoeken menetepi soerat printah tertanggal 29 Juni 1903 No. 959/A.

Terbikin boewat Origineel

Soedah tjotjok dengan Register dan adanja semoewa katrangan

Sous-Chef Secretarie,

Raden Mas Prio



Gambar efkaknya Hadji Djaat di kampung
Krauman, Galuhok No. 124 Blok H. no. 23.

Galan ka Rajonmatan

Galan besar moeka Kapatijan

36.52 d

Hadji Abdulfatah

Hadji Mardjoeki

Kangpundunetjo

Moekmin

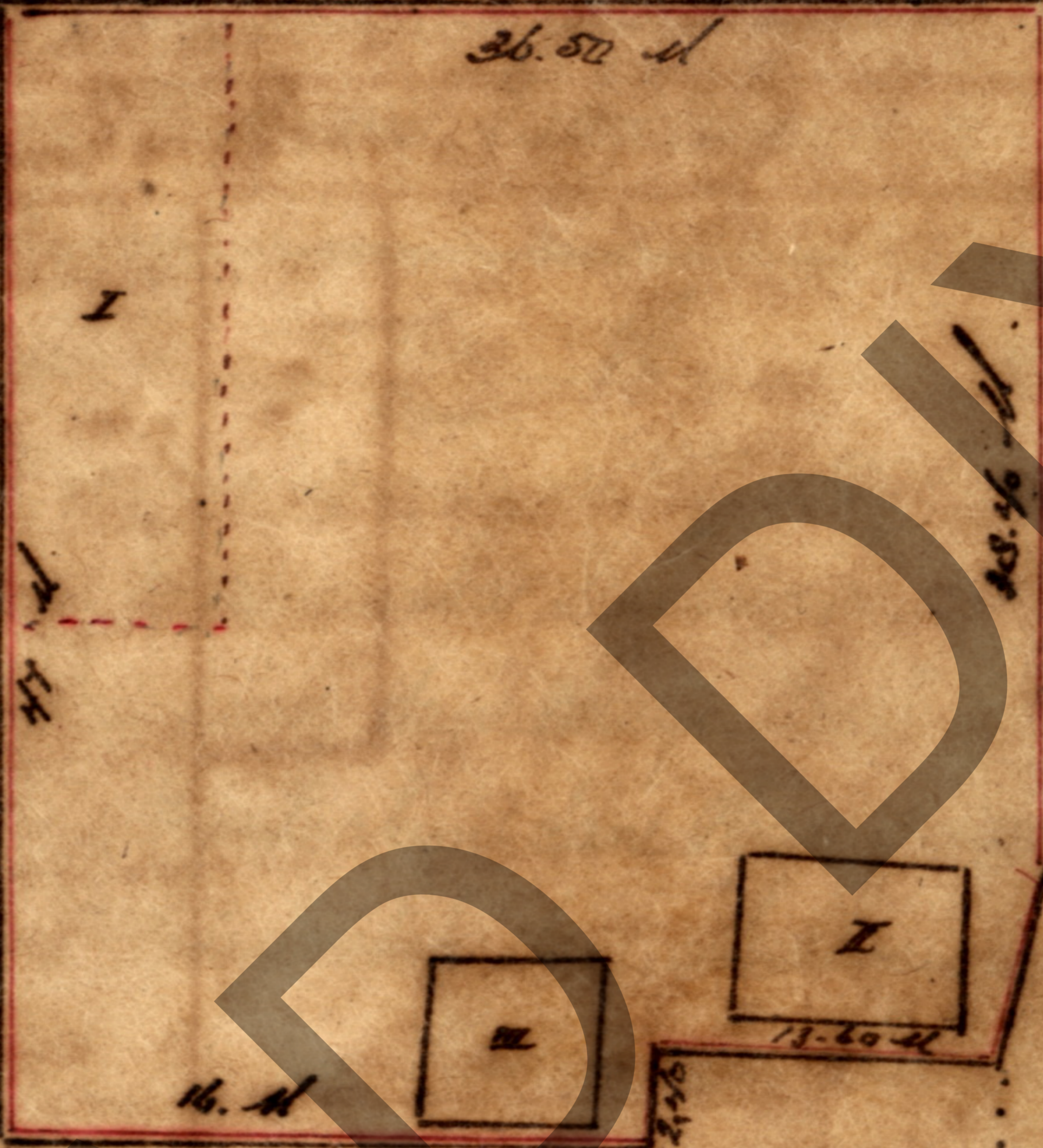

48.46 d

Galan kampung

Hadji Brahim

Hadjarandjojo

Hadji Abdubrahim

— Kikis pekarangan —

No 52.
21-7-1927/40

am 5. 10 9/10 1927

Handwritten text in Malayalam script, appearing to be a list or account of items and their values.

Handwritten text at the bottom of the main section.

Handwritten signature or name.

Handwritten notes on the left side, including the number 3500 and other illegible text.

Large handwritten signature or name in the lower middle section.

Handwritten text: 890/40

Handwritten text in Malayalam script, possibly a date or reference.

Large handwritten signature or name at the bottom right.

Handwritten text at the top of the page, possibly a title or header, in Burmese script.

Handwritten text in Burmese script, located above the main diagram.

Handwritten text on the left side of the page, partially overlapping the diagram's border.

Vertical handwritten text on the left side of the diagram, possibly a label for a boundary or measurement.

Horizontal handwritten text above the main diagram, likely a measurement or label for the top boundary.

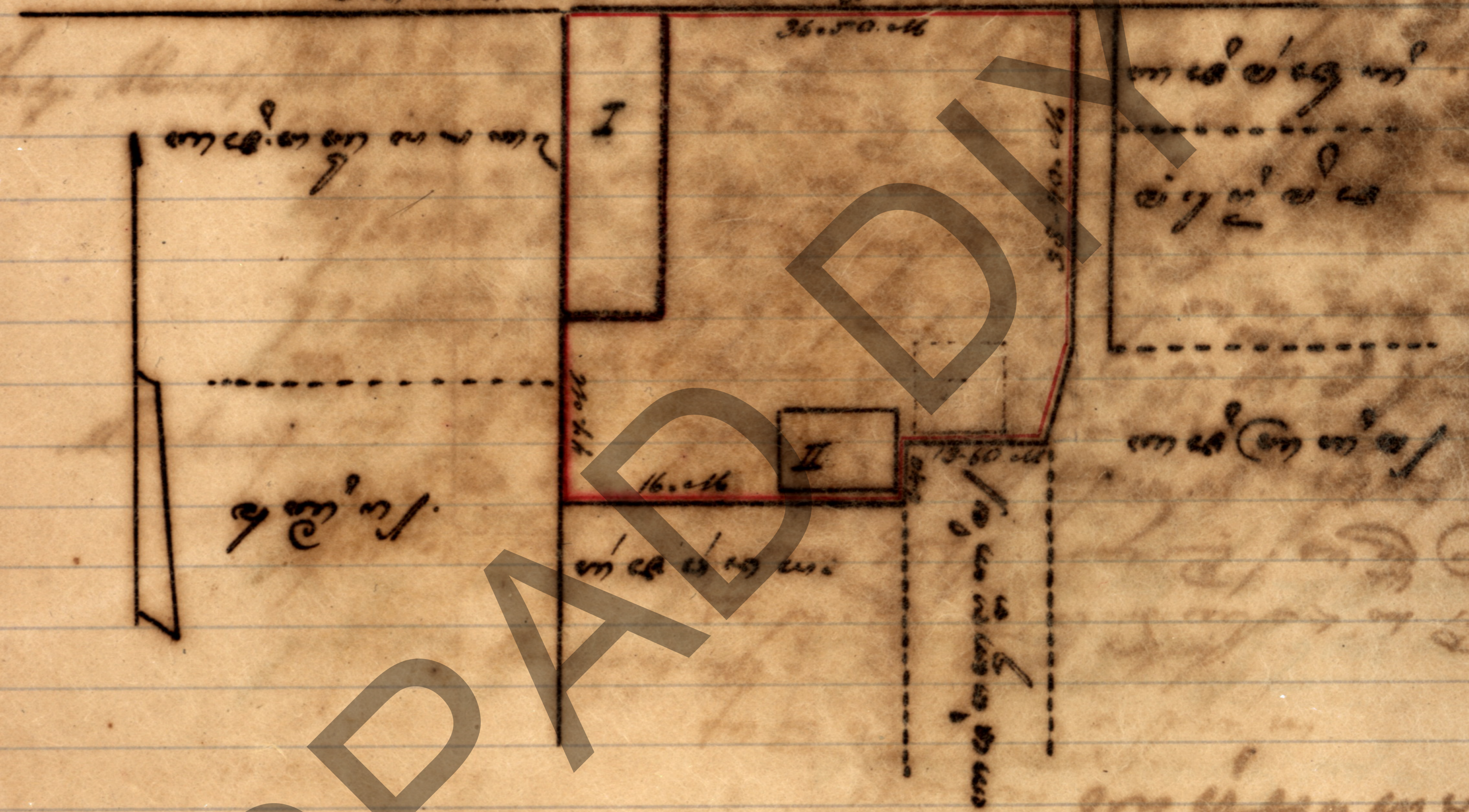

— ကံ့မံ့ပံ့ပံ့ ကံ့မံ့ပံ့ပံ့
 - - - - - I ကံ့မံ့ပံ့ပံ့ ကံ့မံ့ပံ့ပံ့
 I ကံ့မံ့ပံ့ပံ့ ကံ့မံ့ပံ့ပံ့

Handwritten text at the bottom right, including a signature and a date or reference number.

1894. 10. 10. 10. 10.

Handwritten text in Devanagari script, likely a header or introductory section, containing names and dates.

Main body of handwritten text in Devanagari script, consisting of several paragraphs of dense writing.

Handwritten text at the bottom of the page, possibly a signature or a concluding note.

BRAD