

Soerat tetapan di atas hak roemah dengan  
haknja menempati pekarangan.

No. *49/40*

Djokjakarta, *26 Juli*

19 *19*

Lampiran :

Pamarintah di Kadipaten PAKOEALAMAN soedah menetepken jang *Bok Loepinah*  
*Kampung Kapatijan Pakoelaman*  
mendapat hak di atas *Figa* boewah roemah, dengen haknja menempati pekarangan No. *5/a*  
di kampoeng *Kapatijan* Blok *F1* No. *9* Oekoeran pandjang  
*21-20* M. lebar *14.50* M. djadi loewasnja ada *307.40*M<sup>2</sup>. (  R. R.  )  
Tonggo seblah lor *djalan Purwanggan Kidoel / moekah Gneratmasin*  
" " wetan *Bok Loekorejo dan Wangseredjo*  
" " kidoel *Setrositiko*  
" " koelon *R. Nganten Parirodihardjo*  
atsal *belian* dari *Samaridjo di kampoeng*  
*Kaoman Pakoelaman*  
(terseboet pratelan dari Kepala *Kampung Pakoelaman*  
tertanggal *18 Juli 1919*  
No. *51* ) dengen harga f *500-* (terbilang *Lumaratus*  
*roepiah.* ).  
Dan *Bok Loepinah* terseboet di atas di temtoeken menetepi  
soerat printah tertanggal 29 Juni 1903 No. 959/A.

Terbikin boewat

*Origineel*

Soedah tjotjok dengen Register  
dan adanja semoewa katrangan

Sous-Chef Secretarie,

*R. M. Rio*



*[Signature]*



Gambar rumah dan erpja Bek Loepinah di  
 kampung Kapatian tjangkok No 5/1 Blok F<sup>o</sup> No 9.

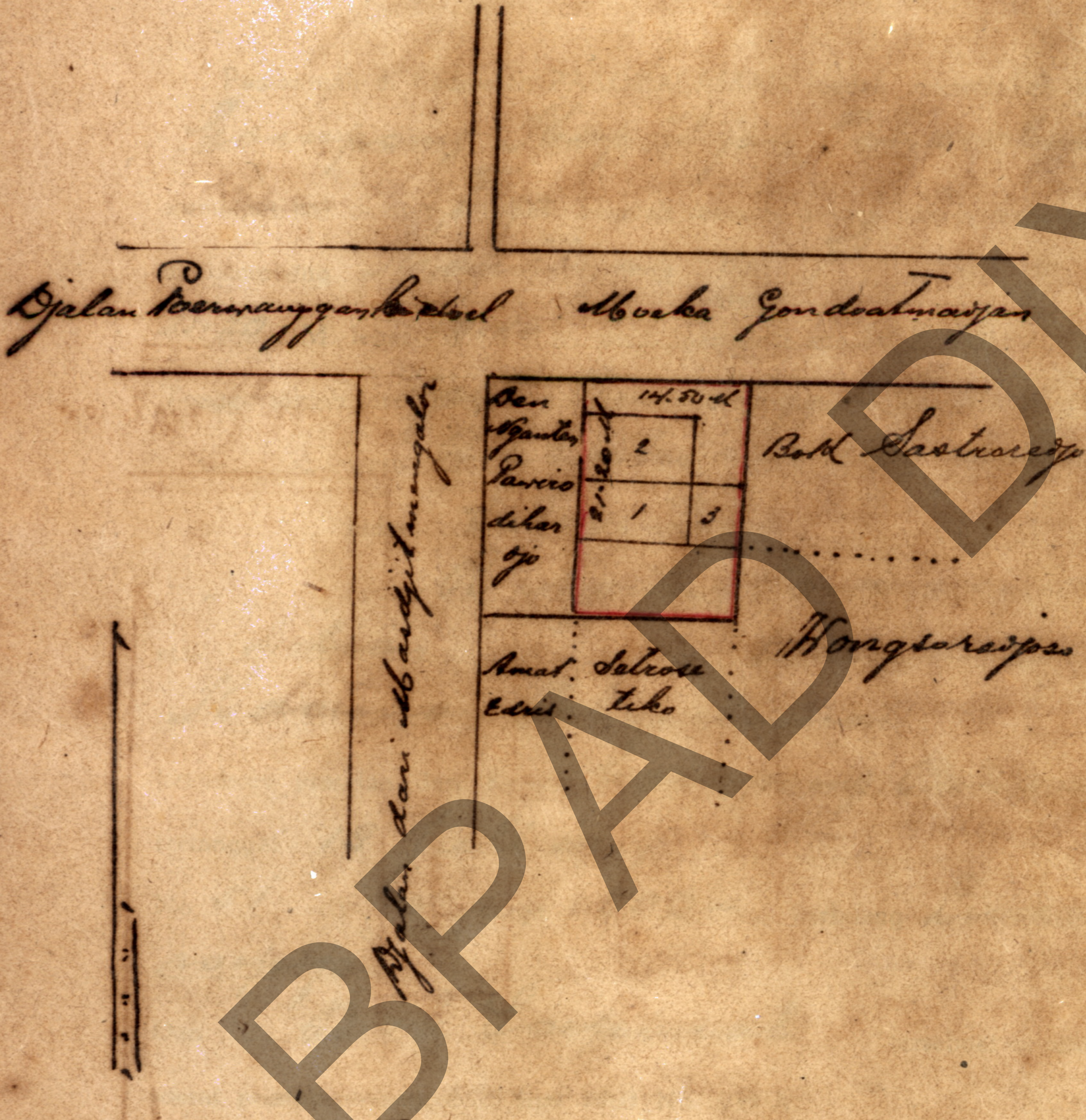

Skici pakarangan  
 Rumah bangun kampung

- no 1
- no 2
- no 3

" muka "

" dapoe "



No 51.  
m n d n d 3.

128 pms 19 26/40  
21 7-19

1 m 3: 10 pms 19 19

Handwritten text in a cursive script, possibly a list or account entry.

- 1. 6 m.
- 1. 7 pms.
- 1. 8 pms.

Main body of handwritten text, including a large signature and various entries.

Small handwritten notes or corrections in the bottom left corner.

Handwritten text at the top of the bottom section.

Large handwritten signature or name.

19/888/40

Handwritten text at the bottom right, possibly a date or reference.

Handwritten signature or name at the bottom right.



Handwritten text at the top of the page, possibly a title or header, written in a cursive script.

Handwritten text above the diagram, likely describing the layout or context of the plan.



- " " " " " "
- no. 1. " " " " " "
- no. 2. " " " " " "
- no. 3. " " " " " "

Handwritten text at the bottom right of the page, possibly a signature or a concluding note.



No. 51

1. 10. 1914

1. 10. 1914  
1. 10. 1914

1. 10. 1914  
1. 10. 1914

1. 10. 1914  
1. 10. 1914

1. 10. 1914  
1. 10. 1914

1. 10. 1914  
1. 10. 1914

1. 10. 1914  
1. 10. 1914

1. 10. 1914  
1. 10. 1914

1. 10. 1914  
1. 10. 1914

1. 10. 1914

BRADLEY



1000 10 10 10

Handwritten text at the top of the page, possibly a header or title, written in a cursive script.

Main body of handwritten text, consisting of several lines of cursive script, likely a letter or a document.

Handwritten text at the bottom of the page, possibly a signature or a closing note.

BRANDY