

Soerat tetapan di atas hak roemah dengan
haknja menempati pekarangan.

N^o 32

Djakakarta, 26 November 1917

Lampiran: V

Pamarintah di Kadipaten PAKOEALAMAN soedah menetepken, jang saorang bernama
Pradjodono beromah kampoeng Bedon (Klwa Gede)
mendapat hak di atas *salo* boewah roemah, dengan haknja menempati pekarangan No. 153
di kampoeng *Margojasan* Blok *P* No. *18* Oekoeran pandjang
 $\left. \begin{matrix} 23.75 \\ 23.8 \end{matrix} \right\} 23.75 \text{ M. lebar } \left. \begin{matrix} 15.8 \\ 15.2 \end{matrix} \right\} 15.5 \text{ M. djadi loewasnja ada } 380. - \text{ M}^2.$
Tonggo sebelah lor *Karsadimedjo*
" " wetan *Pawiroedjo dan R Abdul Boedhwardjo*
" " kidoel *Tondjo pertomo (Pradjodono)*
" " koelon *Muslijoso*
atsal *Beli* dari saorang bernama *Pawiroedjo di*
kampoeng Margojasan Pakse-Blaman
(terseboet pratelan dari Kepala-Kampoeng tertanggal *20 October 1917*
No. *111*) dengan ~~di taksir~~ harga f *200. -* (terbilang *dua ratus*
roepijah)).
Dan *Pradjodono* terseboet di atas di temtoeken menetepi
soerat perintah tertanggal 29 Juni 1903 No. 959/A.

Terbikin boewat

Origineel

Soedah tjotjok dengan Register
dan adanja semoewa katrangan.

Sous-Chef Secretarie.



M. W. A. W. J. O.

Gambar pekarangan N^o 153
 Blok I N^o 18

Djalan Binbaran di moeka Sewandanan

Klinik
 D^r Dewies



Djalan sampei djalan Soerokarsan

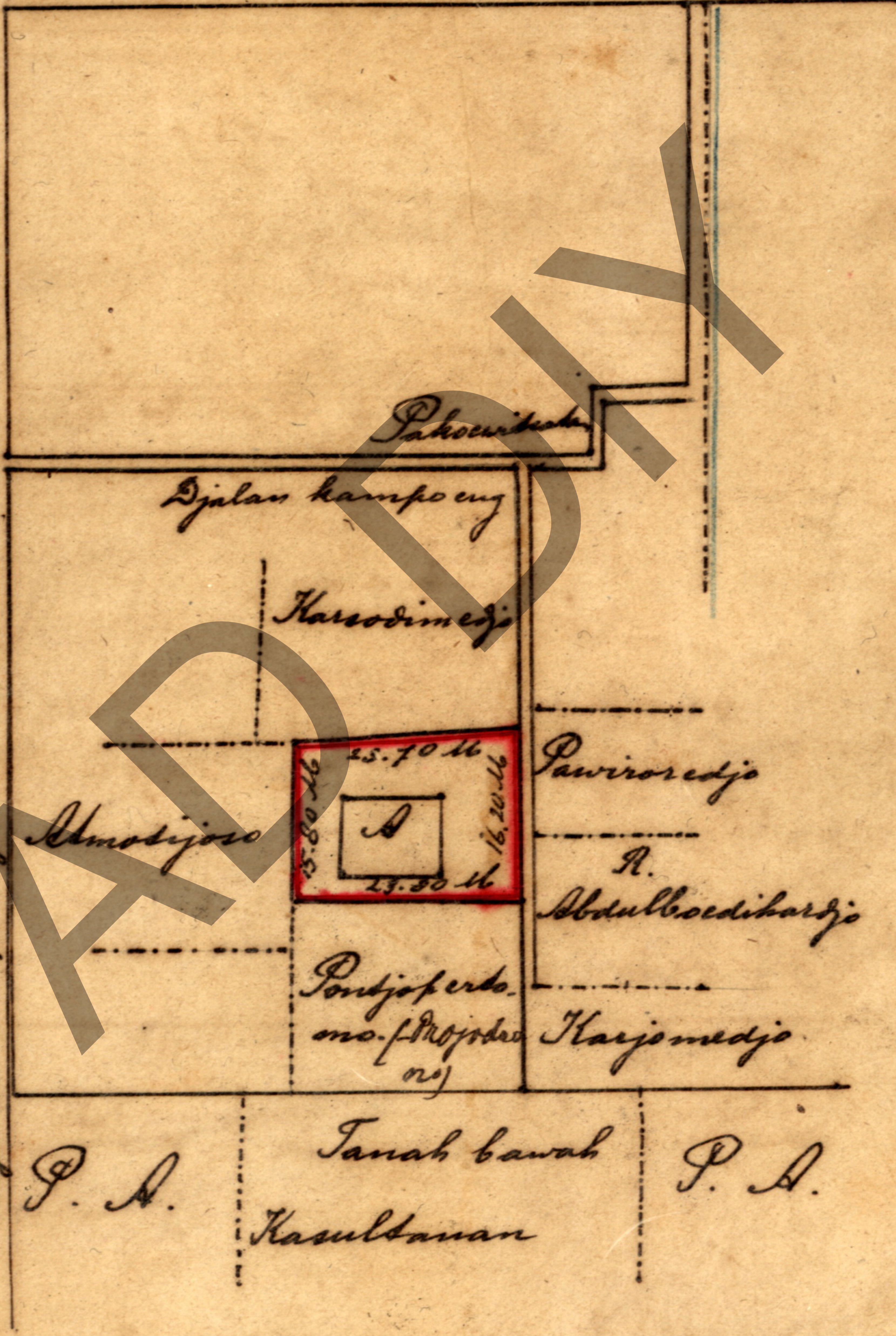

- Kikis pekarangan
- Kalen masoek ka Boewie
- A. Roemah
- - - Kikis dengan tonggo

2000 iii
2000 4

Agkady: no: 1123
24-10-1917

20. 2700. 1917

[Faint handwritten notes in the left margin, possibly including 'Reserve' and '2000']

[Main body of handwritten text, appearing to be a ledger or account record with multiple lines of entries.]

[Handwritten signature or initials on the left side.]

[Handwritten signature or name at the bottom center.]

[Handwritten text at the bottom left, possibly a note or signature.]

No 626 24/10/17
[Handwritten text and signature at the bottom right.]

This is a copy of the original plan of the land
 which is being sold. The land is situated
 in the village of ...

This is a copy of the original plan of the land.

This is a copy of the original plan of the land.



- This is a copy of the original plan of the land.
- This is a copy of the original plan of the land.
- This is a copy of the original plan of the land.

This is a copy of the original plan of the land.

183: 10. 1917

[Faint handwritten text, possibly a header or introductory note, written in a cursive script.]

[Main body of handwritten text, consisting of several lines of cursive script. The text is somewhat faded but appears to be a list or series of entries.]

[A short line of handwritten text, possibly a separator or signature.]

[Handwritten text with a small arrow pointing to the right, possibly indicating a date or reference.]

[Handwritten text, possibly a signature or a closing note.]

[Handwritten text, possibly a date or reference.]

11. 10. 1917

Handwritten notes at the top of the page, including a signature and date.

Main body of handwritten text, starting with a large '1' and several lines of script.

Handwritten note on the left side of the page.

Main body of handwritten text, continuing from the previous section.

Handwritten signature or name.

Handwritten signature or name.