

Soerat tetapan di atas hak roemah dengan  
haknja menempati pekarangan.

DJOKJAKARTA, 26 October 1922.

No. 243/40

Lampiran: 13

Pamarintah di Kadipaten PAKOEALAMAN soedah menetepken jang  
Mas hoerah Wongsowihardjo. beroemah di kampoeng Djagalan. P. A.  
mendapat hak di atas <sup>woewoeng.</sup> ~~sepoeloeboewah~~ roemah, dengan haknja menempati pekarangan No. 143  
di kampoeng Djagalan P. A. Blok C No. 106 Oekoeran pandjang  
52.25 M. lebar 18.35 M. djadi loewasnja ada 957.20M<sup>2</sup> ( R. R. )  
Tonggo seblah lor djalan ketjil sebelah kidoel Sosrowinatan.  
" " wetan Ng. Djoskario dan Wirjopawiro  
" " kidoel M. hoerah Moeljonawiro  
" " koelon h. Wongsowihardjo dan Bok Wongsowirono.  
atsal pembelian dari Bok Amowirono dengan g saudaranya.  
mal waris dari tinggalnja orang kewanja bernama Soerowirono.  
(terseboet pratelan dari Kepala kampoeng kota Pakoealaman.  
tertanggal 20 October 1922  
No. 41 ) <sup>dengan</sup> <sub>di taksir</sub> harga f. 3000.- terbilang ( Tiga riboe roefijah.  
Dan Mas hoerah Wongsowihardjo terseboet di atas di temtoeken menetepi  
soerat printah tertanggal 29 Juni 1903 No. 959/A.

Terbikin boewat *Origineel*

Soedah tjotjok dengan Register

dan adanja semoewa katrangan

Sous-Chef Secretarie,

RADEN MAS RIO,





" 16. 1922  
" 14. 1922

" 20. 1922

No. 40

Agk d f. № 2525 / 40  
21 / 1922

Handwritten text in a cursive script, likely a legal document or contract. The text is dense and covers most of the page. There are several lines of text that appear to be crossed out or corrected. A large watermark "DRAFT" is visible across the center of the page.

Vertical handwritten notes on the left margin, including numbers and possibly names or dates.

Handwritten notes at the bottom left, including a date "25/10-22".

" 1922

Handwritten signature or name.

Handwritten notes at the bottom left, including a date "1922".

Handwritten notes at the bottom right, including a date "1922" and a signature.



20

25/1/1922

Handwritten text in Gurmukhi script, covering most of the page. The text is dense and appears to be a detailed account or report. A large watermark is visible across the center of the page.



10/1/25/1922

Handwritten text at the top of the page, possibly a header or introductory note.

Main body of handwritten text, appearing to be a list or detailed notes.

Handwritten text on the left side, possibly a signature or reference.

Second main body of handwritten text, continuing the list or notes.

Handwritten text at the bottom of the page, possibly a signature or date.





11 Nov 25 / 1922

Handwritten notes at the top of the page, including the date and some illegible text.

Main body of handwritten text, appearing to be a list or series of notes, with some numbers and symbols.

Handwritten notes on the left side, possibly a signature or initials.

Handwritten notes at the bottom left, possibly a signature or initials.

Large watermark text 'BRAD' oriented vertically across the page.





11 am 8. 25 / 19 / 25. 1912.

The first part of the book is a history of the  
of the first part of the book is a history of the  
of the first part of the book is a history of the

The second part of the book is a history of the  
of the second part of the book is a history of the  
of the second part of the book is a history of the

The third part of the book is a history of the  
of the third part of the book is a history of the  
of the third part of the book is a history of the

Brussels, 1912

4  
3  
2

F. L. G. 1912

BRAD



Handwritten text at the top of the page, including a date: 25 / 10 / 1922.

Handwritten text in the upper left section, possibly a signature or a specific note.

Main body of handwritten text, densely packed and written in a cursive style, covering the right half of the page.

Handwritten notes on the left side, including the phrase "Fell. y...".

Large, stylized watermark or logo, possibly reading "BRAD".



2264 1/2 1922

Handwritten notes at the top of the page, including the number 2264 1/2 and the year 1922.

Main body of handwritten notes, containing several paragraphs of text.

Handwritten notes on the left side of the page, including the number 2264 1/2 and the year 1922.

Handwritten notes at the bottom of the page.



1912. 11/11/12

Handwritten text at the top left, possibly a header or address, written in a cursive script.

Main body of handwritten text, consisting of several lines of cursive script.

Handwritten note or signature on the left side of the page.

Full L. ... handwritten text at the bottom left.

Lower section of handwritten text, continuing the main body of the document.

Handwritten text at the bottom center, possibly a signature or date.



25  
1922

Handwritten text in a cursive script, likely a letter or document, located at the top of the page.

Main body of handwritten text in a cursive script, occupying the central portion of the page.

File L. jin...  
8.  
Handwritten notes or signatures on the left side of the page.

Handwritten text at the bottom of the main body, possibly a signature or a closing.

Handwritten text below the main body, possibly a signature or a closing.

Handwritten text at the bottom of the page, possibly a signature or a closing.



25 / 10 / 1922

Handwritten notes at the top of the page, including the date and some illegible text.

Main body of handwritten notes, appearing to be a list or series of entries, though the text is largely illegible due to the cursive script and fading.

Fall L. ...

BRAD

Handwritten notes at the bottom of the page, including a circled signature or name.



226. 1922. 24. 11. 1922

Handwritten notes at the top of the page, including the number 226 and the year 1922.

Main body of handwritten notes, containing several lines of text and a large 'B' watermark.

Handwritten notes at the bottom of the page.



Handwritten text in a cursive script, likely a letter or document. The text is written on aged, yellowed paper with horizontal lines. The script is dense and fills most of the page. A large, semi-transparent watermark reading "BRADY" is overlaid diagonally across the center of the page.

Handwritten text, possibly a date or a specific reference, located in the middle of the page. It appears to be "1867" followed by some illegible characters.

Handwritten text on the left side of the page, possibly a signature or a specific address. It is written in the same cursive script as the rest of the document.

Handwritten signature or name at the bottom left of the page, written in a stylized cursive script.

Handwritten text on the right side of the page, possibly a closing or a specific note. It includes some characters that are difficult to decipher due to the cursive style.



1  
|| ကာကွယ်ရေးဗဟိုဌာနမှ နယ်စပ်ဒေသများတွင် အရေးကြီးသော  
အန္တရာယ်များ ရှိနေပါသဖြင့် အောက်ဖော်ပြပါ အချက်များကို  
ကျင့်ကြံရန် တောင်းဆိုပါသည်။  
၁။ အရေးကြီးသော အန္တရာယ်များ ရှိနေပါသဖြင့်  
အောက်ဖော်ပြပါ အချက်များကို ကျင့်ကြံရန်  
တောင်းဆိုပါသည်။  
၂။ အရေးကြီးသော အန္တရာယ်များ ရှိနေပါသဖြင့်  
အောက်ဖော်ပြပါ အချက်များကို ကျင့်ကြံရန်  
တောင်းဆိုပါသည်။  
၃။ အရေးကြီးသော အန္တရာယ်များ ရှိနေပါသဖြင့်  
အောက်ဖော်ပြပါ အချက်များကို ကျင့်ကြံရန်  
တောင်းဆိုပါသည်။

အောက်ဖော်ပြပါ အချက်များကို ကျင့်ကြံရန်  
တောင်းဆိုပါသည်။ ၂၆ ဇူလိုင် ၁၉၇၂ ခုနှစ်

အောက်ဖော်ပြပါ အချက်များကို ကျင့်ကြံရန်  
တောင်းဆိုပါသည်။  
၂၆ ဇူလိုင် ၁၉၇၂ ခုနှစ်  
အောက်ဖော်ပြပါ အချက်များကို ကျင့်ကြံရန်  
တောင်းဆိုပါသည်။

အောက်ဖော်ပြပါ အချက်များကို ကျင့်ကြံရန်  
တောင်းဆိုပါသည်။ အရေးကြီးသော အန္တရာယ်များ ရှိနေပါသဖြင့်



Handwritten text in a script, likely Devanagari, covering the entire page. The text is dense and appears to be a list or a series of entries, possibly related to a historical or administrative record. The script is written in dark ink on aged, yellowish paper. A large, semi-transparent watermark 'BPR' is visible across the center of the page.

BPR



Handwritten text at the top right, possibly a date or reference number.

Main handwritten text on the left side, consisting of several lines of cursive script.

Handwritten text in the middle right section, appearing as a signature or name.

Handwritten text at the bottom right, including a date and possibly a location or recipient name.

Large diagonal watermark text reading 'BRAD DIY' across the center of the page.



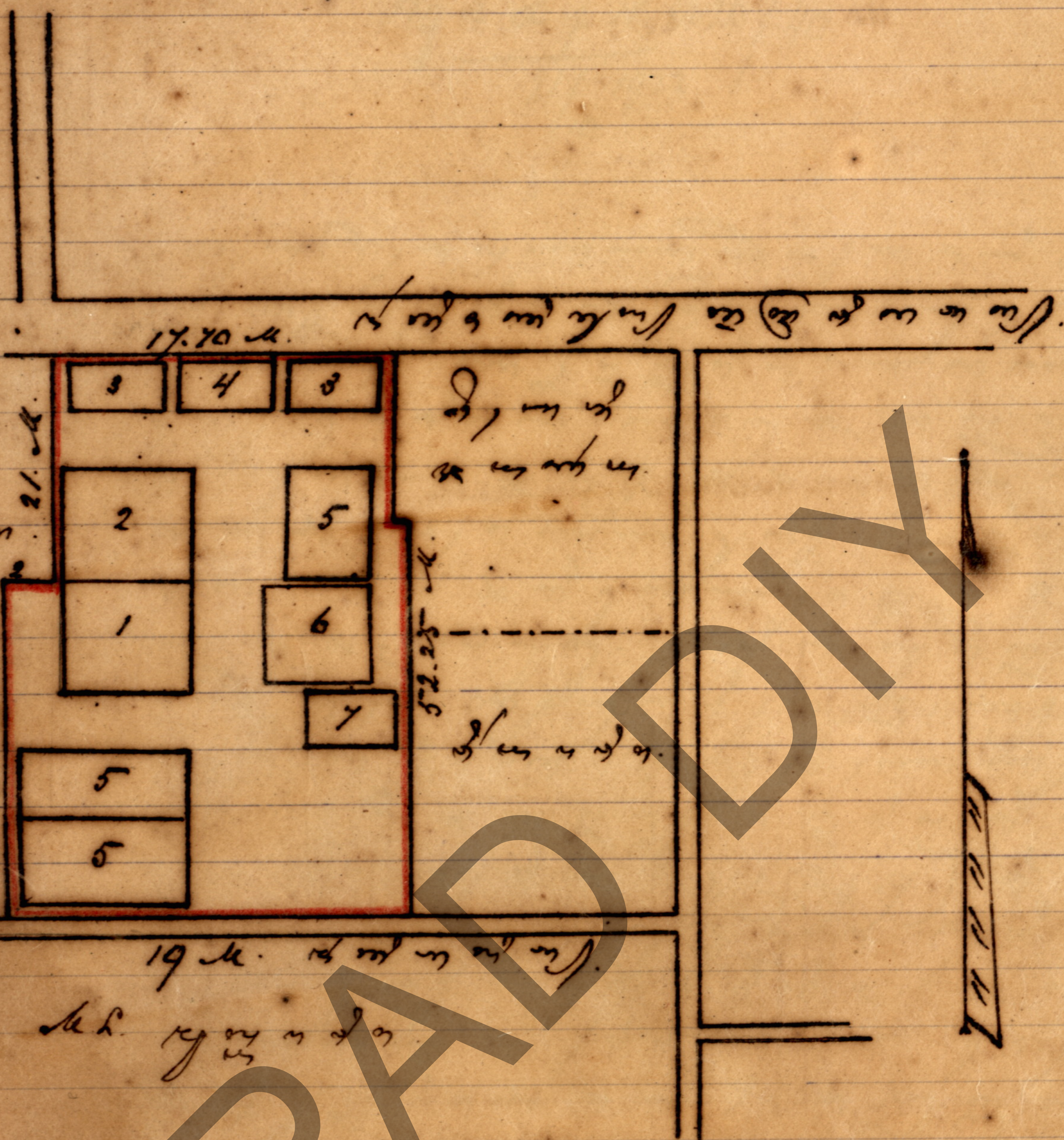

Handwritten Arabic text at the top of the page, possibly a title or header.

- 1. ...
- 2. ...
- 3. ...
- 4. ...
- 5. ...
- 6. ...
- 7. ...

Handwritten Arabic text at the bottom of the page, possibly a signature or concluding note.



Gambar roemah-roemah dan wewenang pekarangan kaposenjakanja  
 M. Loerah Wongsowihardjo, terletak di kampung Djagalan Takoe Alaman  
 tjangkok erf no 143 blok c no 106

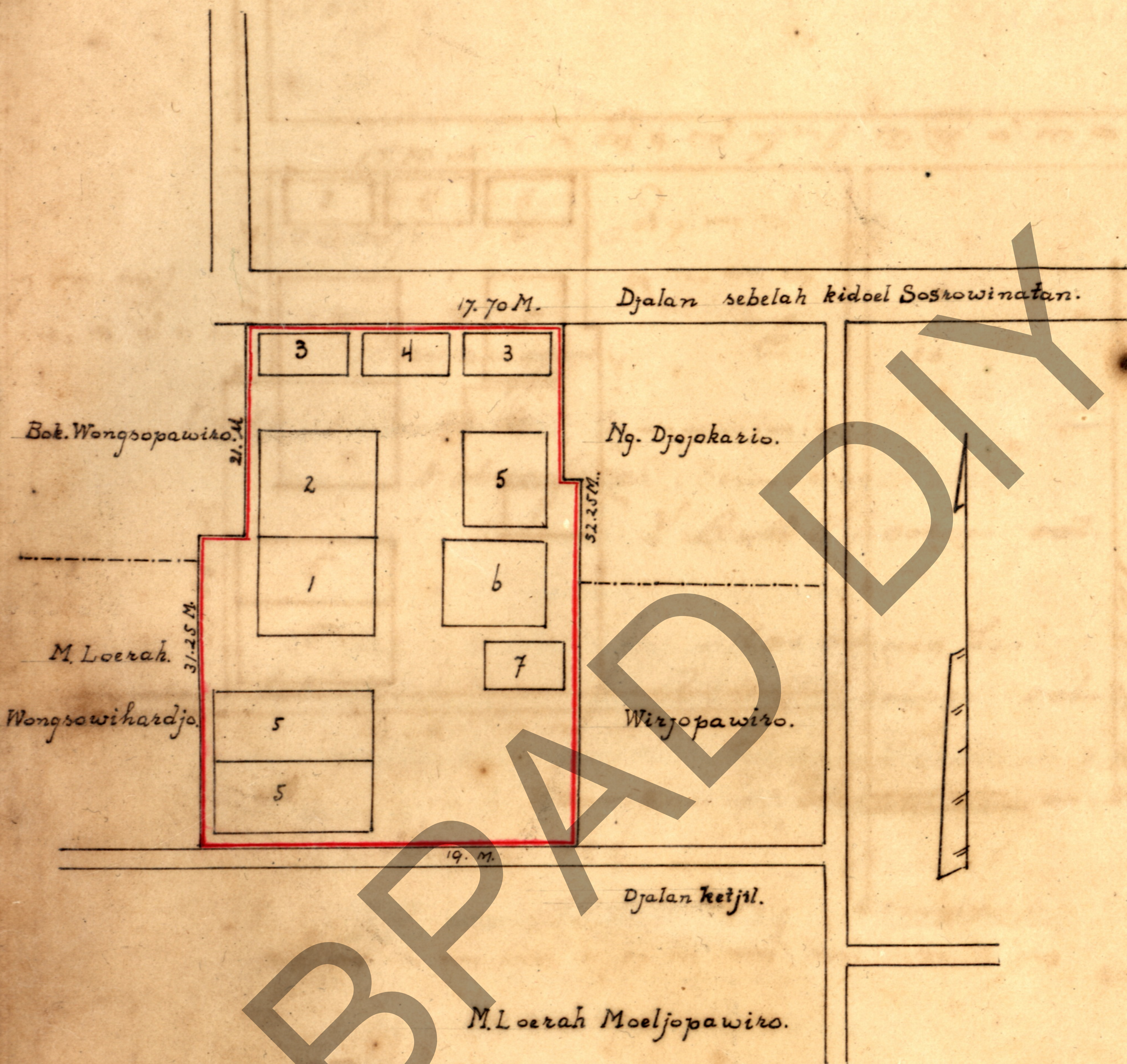

           kikis pekarangan.

- no 1 roemah.
- 2 roemah moeka [pendopo]
- no 3 roemah limassan
- 4 regol.
- 5 roemah limassan
- 6 " gandok
- 7 " koelah.