

Soerat tetapan di atas hak roemah dengan
haknja menempati pekarangan.

No. 26/40

Djokjakarta, 20 Maart 1919

Lampiran : IV

Pamarintah di Kadipaten PAKOEALAMAN soedah menetepken, jang saorang bernama
Pramiodikromo, habdidalem elidji, beromah di kampoeng Sedoksari P.A.
mendapat hak di atas tiga boewah roemah, dengan haknja menempati pekarangan No. 299
di kampoeng Sedoksari Blok 2 No. 88 Oekoeran pandjang
29 2/10 M. lebar 14 2/5 M. djadi loewasnja ada 406 2/50 456 M². (R. R).
Tonggo seblah lor bekel Kromokartiko
" " wetan Kromohardjo dan Moeliosaidiro
" " kidoel Kagongandalem kandang kerbau
" " koelon kali Gode
atsal beli dari saorang bernama Kertolaromo, kampoeng
Sedoksari
(terseboet pratelan dari Kepala kampoeng kota Pakoe Alaman
tertanggal 10 Maart 1919
No. 22) dengan harga f 600 (terbilang Anem ratus roepiah
di taksir).
Dan Pramiodikromo terseboet di atas di temtoeken menetepi
soerat printah tertanggal 29 Juni 1903 No. 959/A.

Terbikin boewat

Origineel

Soedah tjotjok dengan Register
dan adanja semoewa katrangan

Sous-Chef Secretarie,



99/1

Gambar rumah dan pekarangannya Pramiodikromo
 di kampung Sedoksari, erf No 299 blok D. No 88

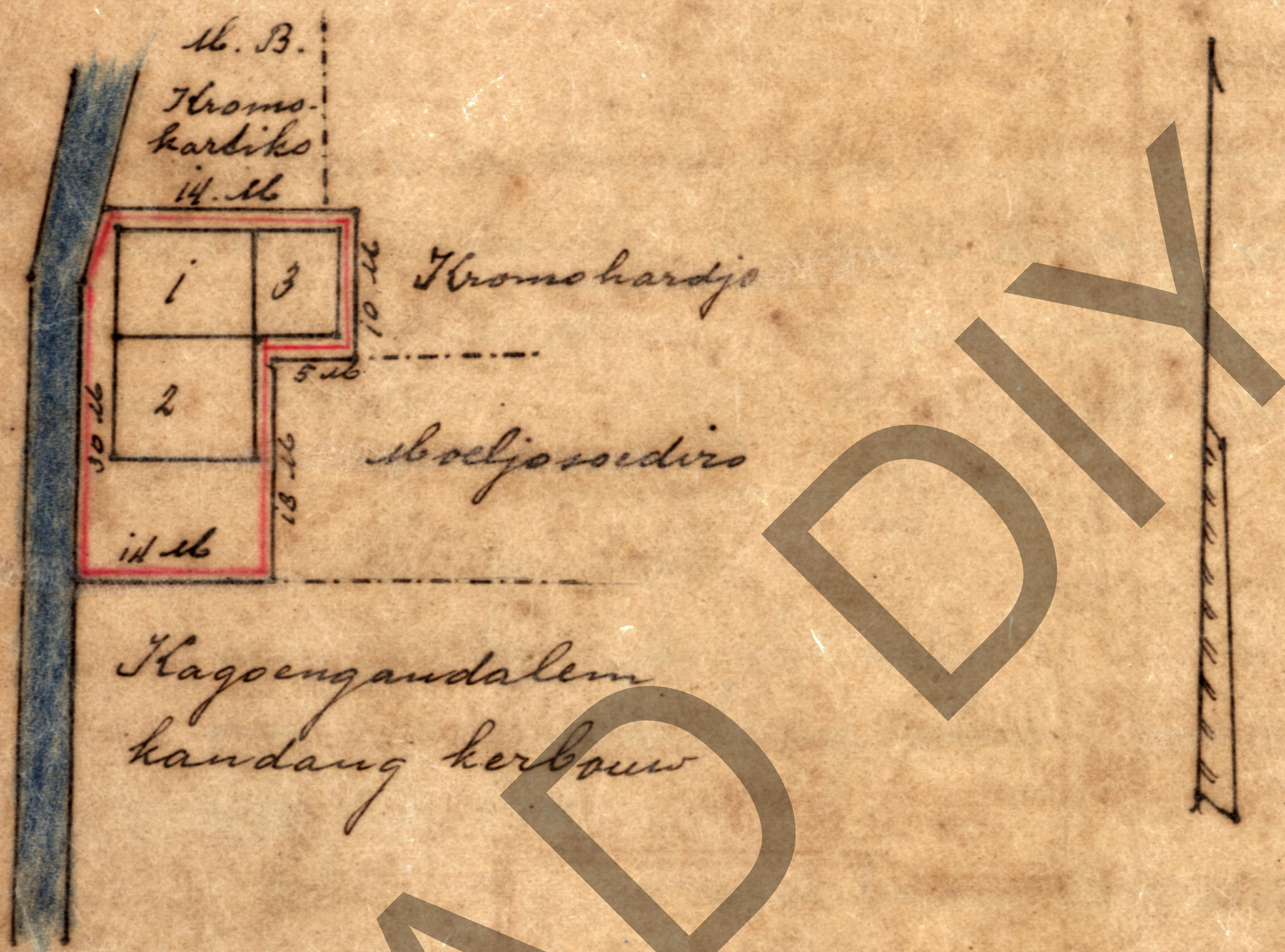

- Batas pekarangan
Kali Tjode
 No 1. Rumah bangsai limasan
 No 2. Pendopo " "
 No 3. Pawon " kampung

No. 22

10/10/1919

Agkady: № 693/40
11-3-1919

10/10/1919

[Vertical handwritten notes in the left margin]

[Main body of handwritten text, appearing to be a list or detailed notes]

[Handwritten line of text]

№ 216

[Handwritten notes at the bottom left]

[Handwritten notes at the bottom right]

[Large handwritten signature]

Handwritten text at the top of the page, likely a title or introductory notes, written in a cursive script.

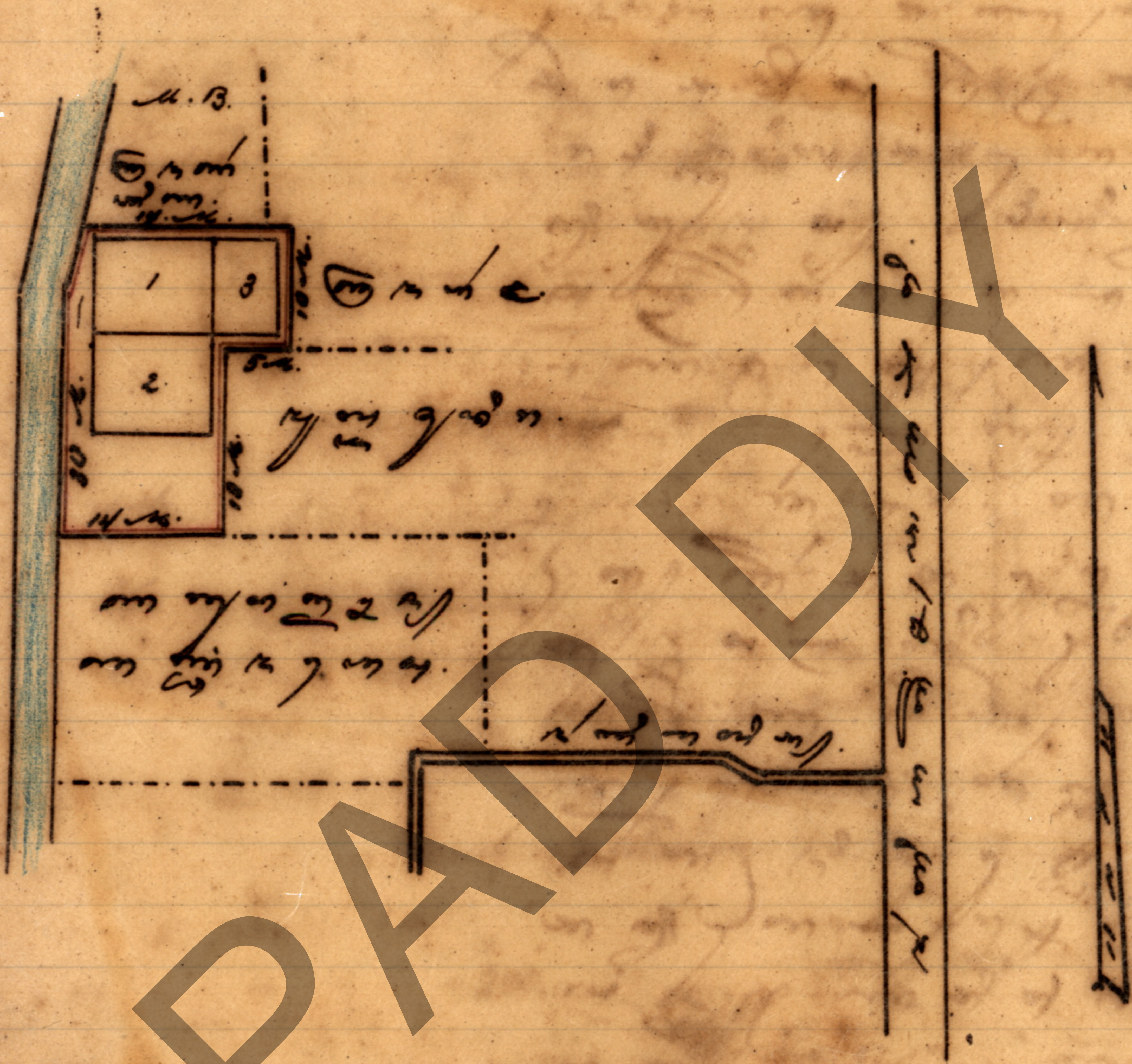

Handwritten text below the diagram, including a legend with colored lines (red and blue) and descriptive notes.

Handwritten text at the bottom of the page, possibly a signature or a concluding note.

1919. 29. 11. 11

1. 2. 3. 4. 5. 6. 7. 8. 9. 10. 11. 12. 13. 14. 15. 16. 17. 18. 19. 20. 21. 22. 23. 24. 25. 26. 27. 28. 29. 30. 31. 32. 33. 34. 35. 36. 37. 38. 39. 40. 41. 42. 43. 44. 45. 46. 47. 48. 49. 50. 51. 52. 53. 54. 55. 56. 57. 58. 59. 60. 61. 62. 63. 64. 65. 66. 67. 68. 69. 70. 71. 72. 73. 74. 75. 76. 77. 78. 79. 80. 81. 82. 83. 84. 85. 86. 87. 88. 89. 90. 91. 92. 93. 94. 95. 96. 97. 98. 99. 100.

Handwritten notes in a cursive script, possibly a ledger or account book, with various entries and numbers. The text is written on lined paper and includes several circled numbers and some larger numbers like 1000 and 100. The entries appear to be organized in a list-like format, possibly representing a sequence of transactions or items.

Handwritten signature or name at the bottom right of the page.